

COMMUNITY MEETING INVITATION

File No. PDC15-023

Date: Tuesday, October 13, 2015
Time: 6:30 - 7:30 p.m.
Meeting Location: Masonic Lodge
Red Lodge Room
2500 Masonic Drive, San Jose, CA 95125
Project Location: 1777, 1781, 1787, and 1797 Almaden Road, San Jose, CA 95125

Dear Neighbor,

You're invited! The City of San José Planning Division would like to invite you to a community meeting about a proposed Planned Development Rezoning request from a private applicant in your area (see attached map). Planning staff will be facilitating the meeting, and the private property owner/applicant will present their request. The meeting will provide you with an opportunity to learn about the proposal and receive answers to your questions. The City of San Jose is very interested in your input on this proposal and encourages your attendance at this meeting. The Planning Division will consider all comments during our evaluation of the applicant's proposal.

Proposal:

Planned Development Zoning of six properties from the R-M Multiple Residence Zoning District and the R-1-5 Single-Family Residence Zoning District to the A(PD) Planned Development Zoning District to allow for up to 92 multi-family residential units in a six-story building on an approximately 0.99 gross acre site.

Your participation in the planning process will help us analyze the request and consider the community's input. If you have any questions before the meeting or during the process, please contact:

City of San José:
Planning Division
Project Manager: Liz Schuller
Email: elizabeth.schuller@sanjoseca.gov
Phone: (408) 535-6862

Applicant:
Contact: Tim Henderson
E-mail: tim@cypress-re.com
Phone: (408) 367-8813

Muốn biết tin tức bằng tiếng Việt Nam về tờ thông tin này, xin quý vị liên lạc Sylvia Do ở số 408 535-7907 và đọc số dự án [PDC15-023](#).

Para información en Español acerca de esta solicitud, comuníquese con Elizabeth Zepeda al 408-535-7868 y indique el número de proyecto [PDC15-023](#).

Project Location: 1777 Almaden Road, San Jose



Directions from Project Site to Community Meeting Location

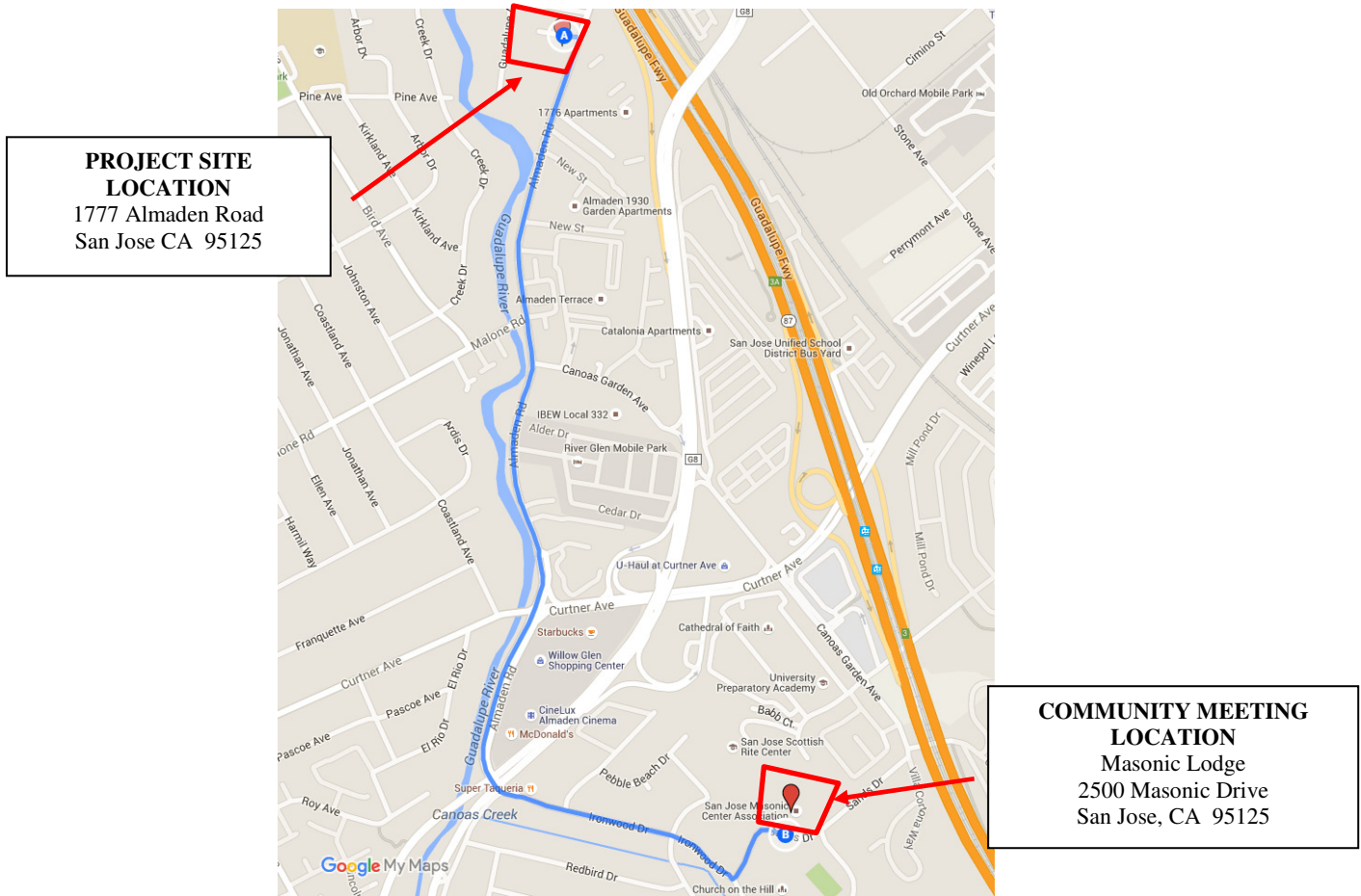

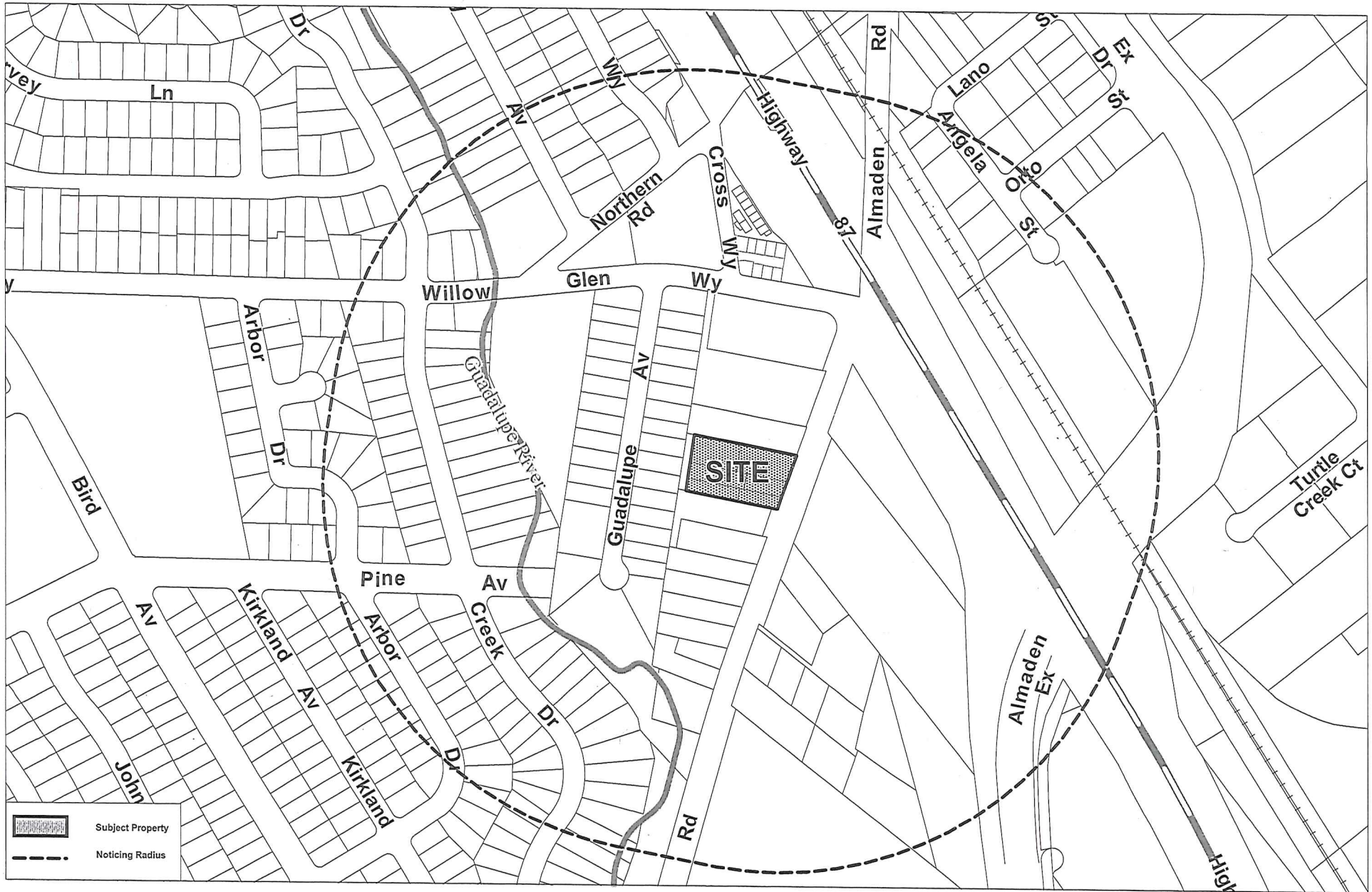

File No: PDC15-023

District: 6

Noticing Radius: 1,000 FEET



Prepared by the Department of Planning,
Building and Code Enforcement
08/13/2015